

## Bailey Bracket

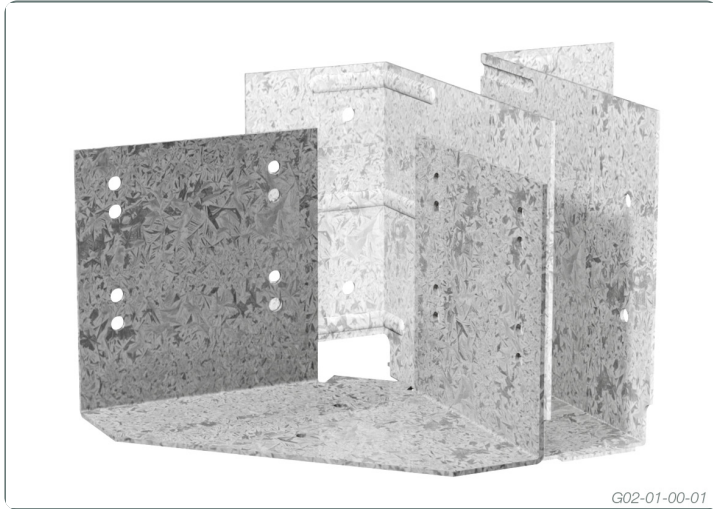

A unique steel bracket used in conjunction with an Easy Fix Girder Bracket for fixing hip trusses or rafters to the side of timber girder truss chords or timber beams

These pre-punched and formed galvanised steel bracket:  
Can be used for both left and right hand side positioning against an Easy Fix Girder Bracket.  
Makes securing hips to girder trusses structurally sound.

### APPLICATION



#### Step 1

Position and fix the Easy Fix Girder Bracket as per standard application (refer to Easy Fix Girder Bracket Product Brochure for full application details).



#### Step 2

Position the Bailey Bracket to align correctly with the Easy Fix Girder Bracket, making sure the screw holes for both brackets are positioned on top of one another.

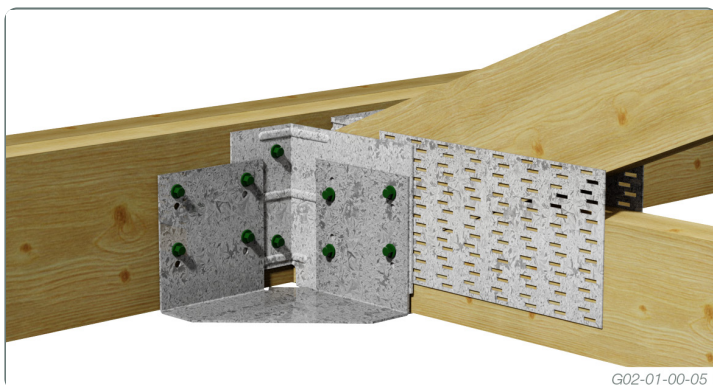

#### Step 3

Secure the Bailey Bracket to the Easy Fix Girder Bracket and Girder Truss using 8/35mm Green Tip #12 Screws.

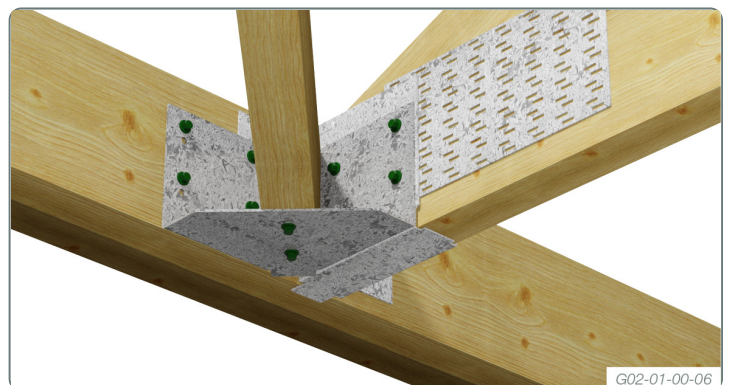

#### Step 4

Position and secure the carried hip truss using 2/65mm Green Tip #12 Screws.

## LOADS CARRIED

The Bailey Bracket provides an easy method to carry internal hip heels butting into two girders. To further assist in the evaluation of these spans, please refer to the Load Table noted below.

## TYPICAL LAYOUT

The following layout depicts the common use of the Multinail Bailey Bracket.

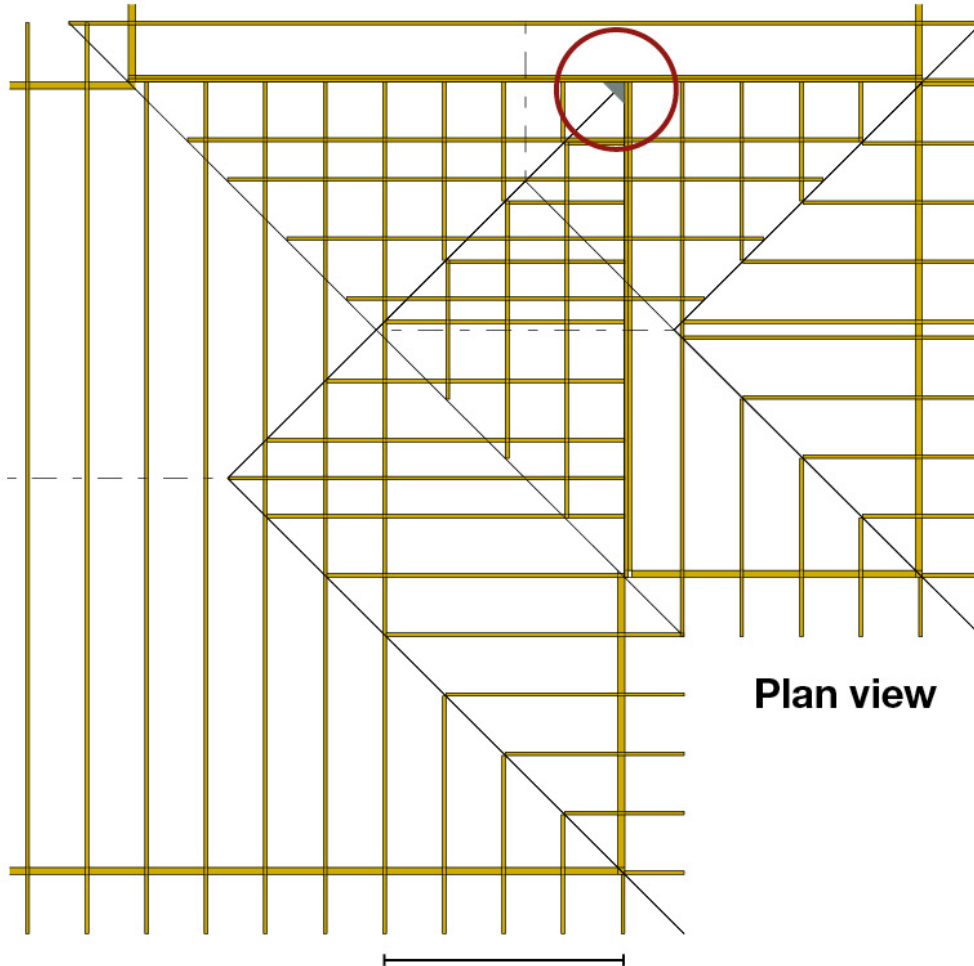

For maximum hip station see note

G02-01-00-07

## LIMIT STATE DESIGN LOADS

### Tie-down capacity

Joint Group	Dead + Wind Load (kN)
JD3	5.2
JD4	3.9
JD5	3.1

### NOTES:

- The capacities for Limit State Design are applicable for all trusses in domestic structures.
- Table capacities have been derived from AS1720.1 - Timber Structures.
- For higher uplifts use 1 x Cyclone Tie wrapped over hip and under both girders. Uplift capacity can be increased to 13kN.
- For dead and live loads the maximum hip station is 3.6m for tile roof or 4.8m for sheet roof.

DESCRIPTION AND PACKAGING

Manufactured from 1.9mm Galvanised G300 Z275 Steel

Description	Product Code	Reference Code	Carton quantity	Carton kg.
Bailey Bracket	TA350	BB-20	20	6.5
35mm Green Tip #12 Screw (TA221), 65mm Green Tip #12 Screw (TA222)				

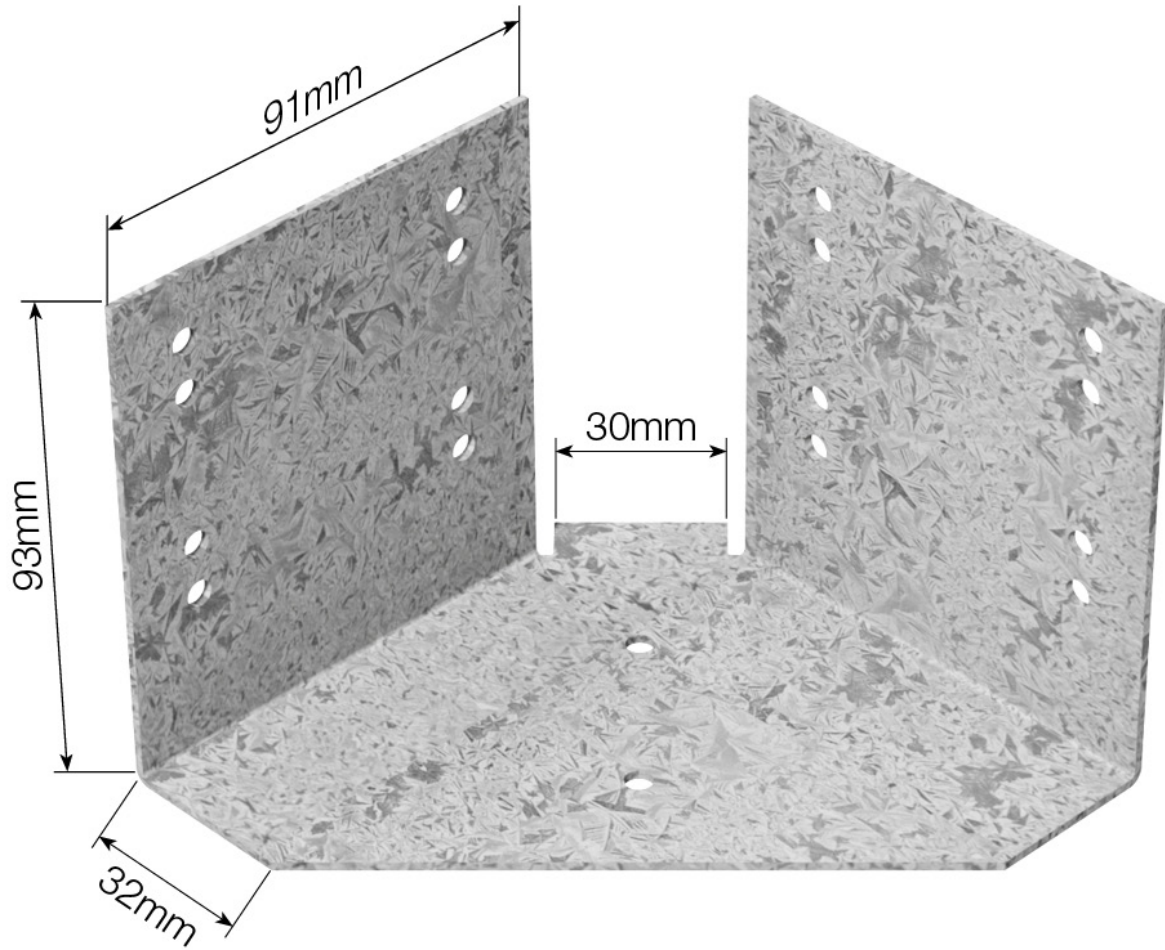

G02-01-00-02

Due to continual product improvement Multinail Australia Pty Ltd. reserves the right to change the product/s depicted - both in description and specification. This document has to be read in conjunction with Multinail's Technical Manual.