

Bearing Plates

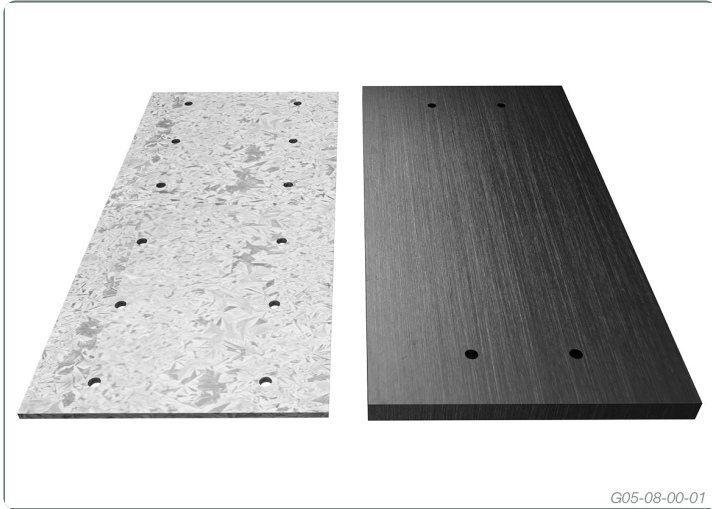

Bearing Plates provide improved bearing capacity for timber top plates

Bearing Plates are manufactured from 2.0mm and 6mm galvanized steel and are:

- Quick and easy to install.
- An improvement to timber bearing capacities for heavier loads.

APPLICATIONS

2mm Bearing Plate

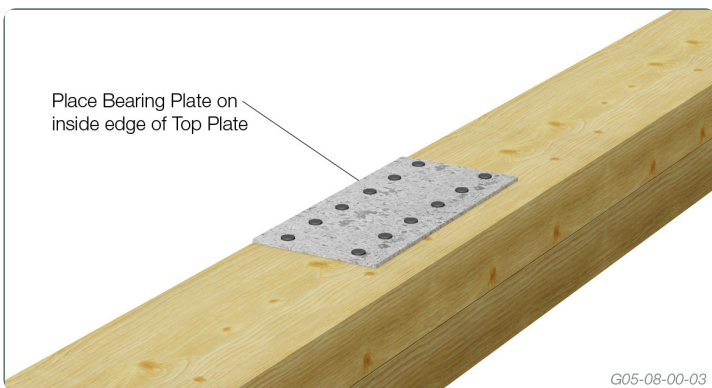

6mm Bearing Plate



The Strength Group for SD6 - E.g. Seasoned Radiata Pine and other mixed Australian grown pine

Wall Thickness	Truss Thickness (mm)	Timber Strength Group	Maximum Bearing Capacity (kN) Dead Load - 1.35DL			
			Without Bearing Plate	2mm Bearing Plate	6mm Bearing Plate	Minimum Stud Width
70	35	SD6	9.7	10.8	16.4	2/35
	45	SD6	12.5	13.6	19.2	2/35
	70	SD6	19.5	20.6	26.2	3/35
	90	SD6	25.1	26.2	31.8	3/45
90	35	SD6	12.5	14.0	21.1	2/35
	45	SD6	16.1	17.5	24.7	2/35
	70	SD6	25.1	26.5	33.7	3/35
	90	SD6	32.3	33.7	40.9	3/45

The Strength Group for SD4 - E.g. Seasoned Victorian Ash & other mixed Australian hardwood

Wall Thickness	Truss Thickness (mm)	Timber Strength Group	Maximum Bearing Capacity (kN) Dead Load - 1.35DL			
			Without Bearing Plate	2mm Bearing Plate	6mm Bearing Plate	Minimum Stud Width
70	35	SD6	20.1	22.4	34.0	2/35
	45	SD6	25.9	28.2	39.7	2/35
	70	SD6	40.3	42.6	54.1	3/35
	90	SD6	51.8	54.1	65.7	3/45
90	35	SD6	25.9	28.9	43.7	2/35
	45	SD6	33.3	36.3	51.1	2/35
	70	SD6	51.8	54.8	69.6	3/35
	90	SD6	66.7	69.6	84.5	3/45

Note:

- Softwood (SD6) - Max. Bearing Stress = 10MPa (1.35DL) with a Capacity Factor (ϕ) of 0.7
- Hardwood (SD4) - Max. Bearing Stress = 17MPa (1.35DL) with a Capacity Factor (ϕ) of 0.85

DESCRIPTION AND PACKAGING

Manufactured from 2.0mm and 6.0mm Galvanised G300 Z275 Steel

Description	Product Code	Reference Code	Carton quantity	Carton kg.
70 x 150 x 2.0	BP70150	BP070150	100	18.5
75 x 150 x 6.0	HBP75150	HBP75150	10	5.2

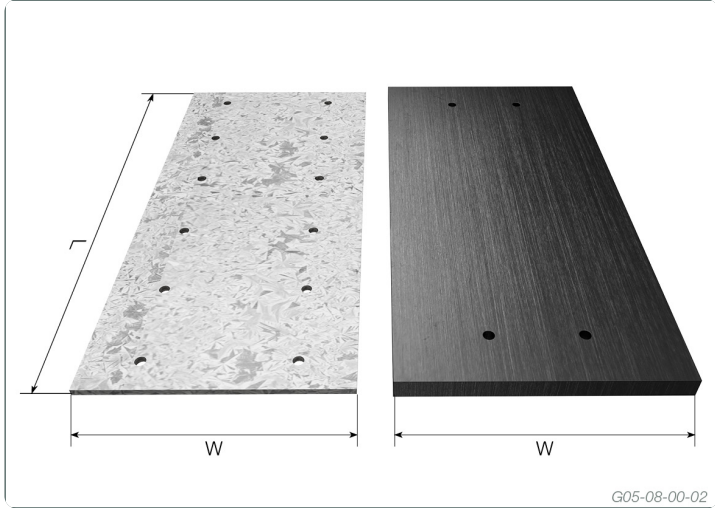

Due to continual product improvement Multinail Australia Pty Ltd. reserves the right to change the product/s depicted - both in description and specification. This document has to be read in conjunction with Multinail's Technical Manual.