

Installation Guide – MegaHold Down Bracket Face Outside

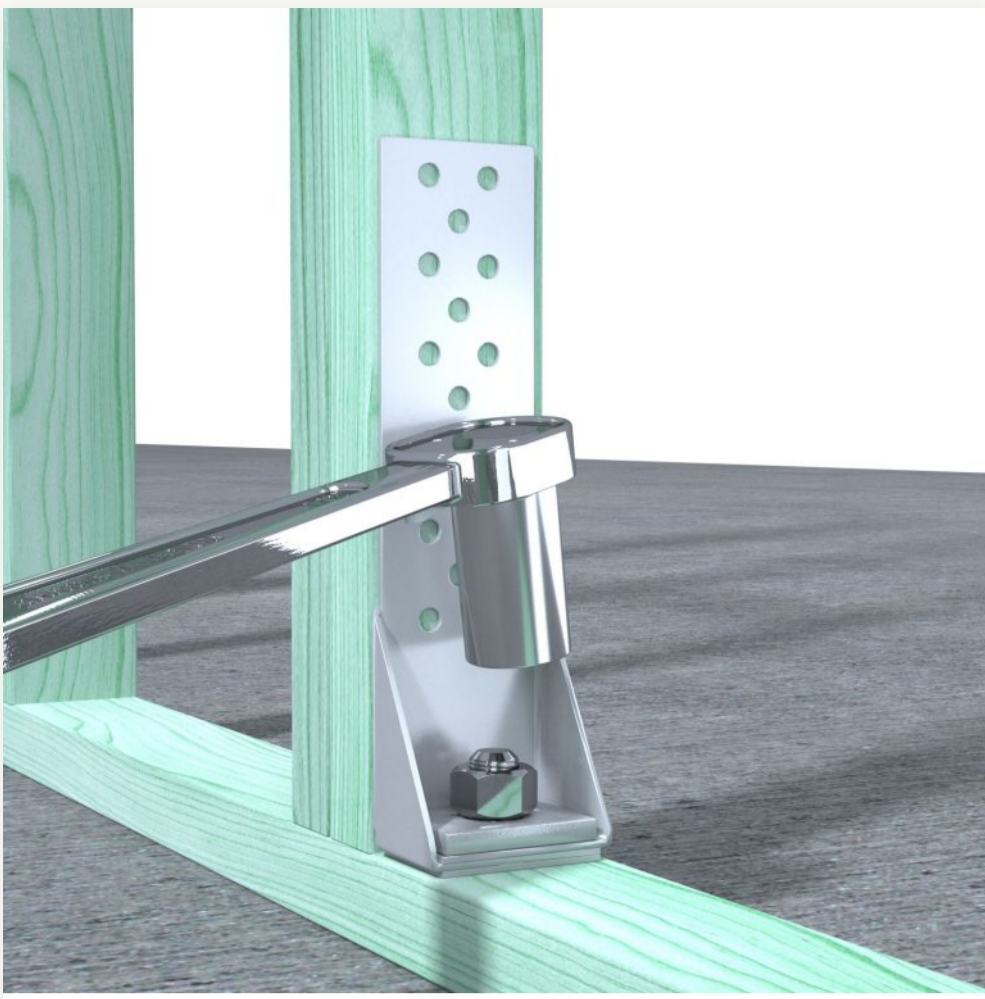

Step 1

Fix the anchor* in the concrete slab through the wall bottom plate at the designed location without tightening it. Then, place the MegaHold Down bracket with the washer plate through. Apply adequate torque to tighten the concrete anchor according to the anchor supplier's instructions.

Anchor:*

M20 for Small and Medium Short Wall Bracing kits (STD200-100, STD200-150, STD320-100 & STD320-150)

Note: Concrete Anchor is not included.



Step 2

Insert the glulam short wall member in the pocket of the wall panel and temporarily prop the glulam.



Step 3

Pre-drill all screws with a 5.0mm diameter drill bit. Pre-drilled hole depth shall be similar to but no deeper than the penetration depth of the screw.



Step 4

Install the screws. Fill all the holes on the MegaHold Down bracket. The recommended torque setting is to be no more than 10 N.m.

Repeat steps 1 to 4 for installing the bracket on the opposite side.

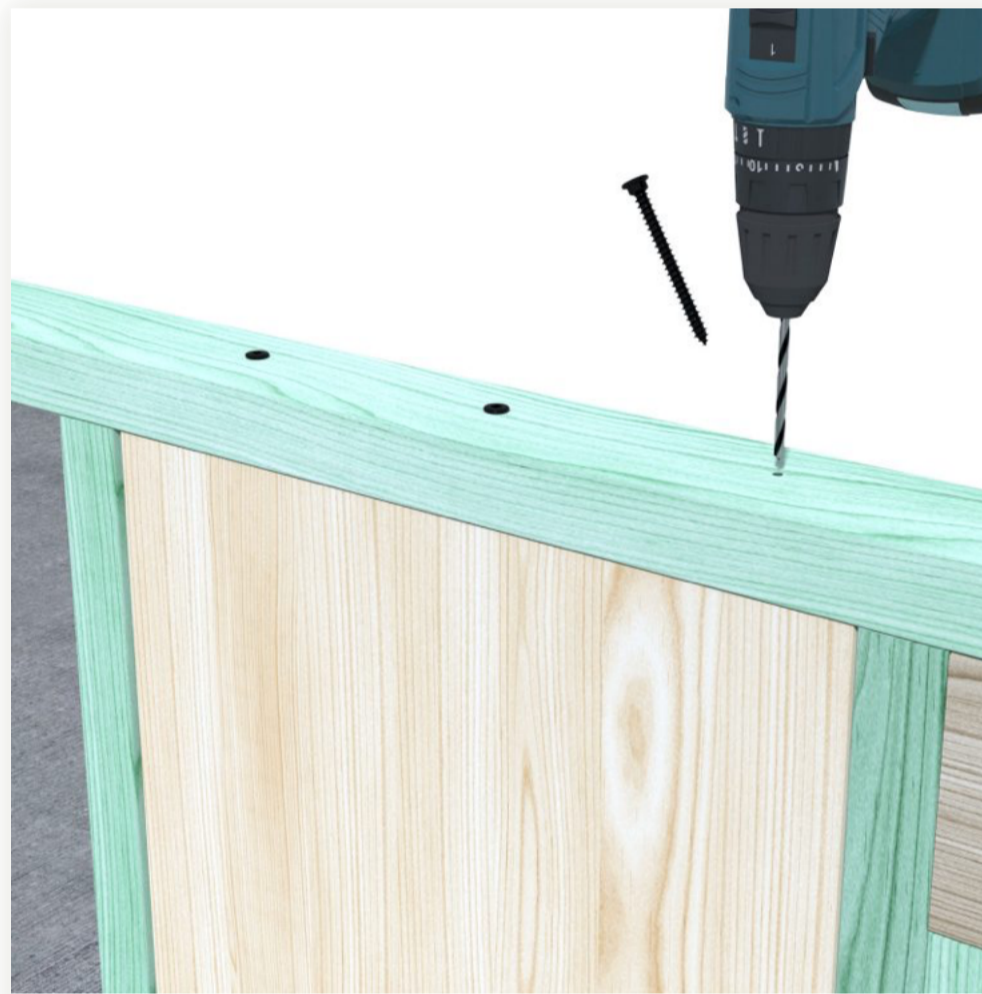

Step 5

Pre-drill* screw locations and install** following number of screws to fix the top plate to glulam:

- 3 screws for GLT size up to 360
- 4 screws for GLT size up to 500
- 5 screws for GLT size up to 600

Pre-drill:* Pre-drill screw location with a 5mm diameter drill bit. Pre-drill hole depth shall be similar to but no deeper than the penetration depth of the screws.

*Install**:* The recommended torque setting is to be no more than 10 N.m.



Step 6

Pre-drill* screw locations and install** screws from the studs to the glulam short wall member at 600mm maximum spacing along the full length of the stud. Ensure that each screw embeds into the GLT member by at least 56mm.

Pre-drill:* Pre-drill screw location with a 5mm diameter drill bit. Pre-drill hole depth shall be similar to but no deeper than the penetration depth of the screws.

*Install**:* The recommended torque setting is to be no more than 10 N.m.

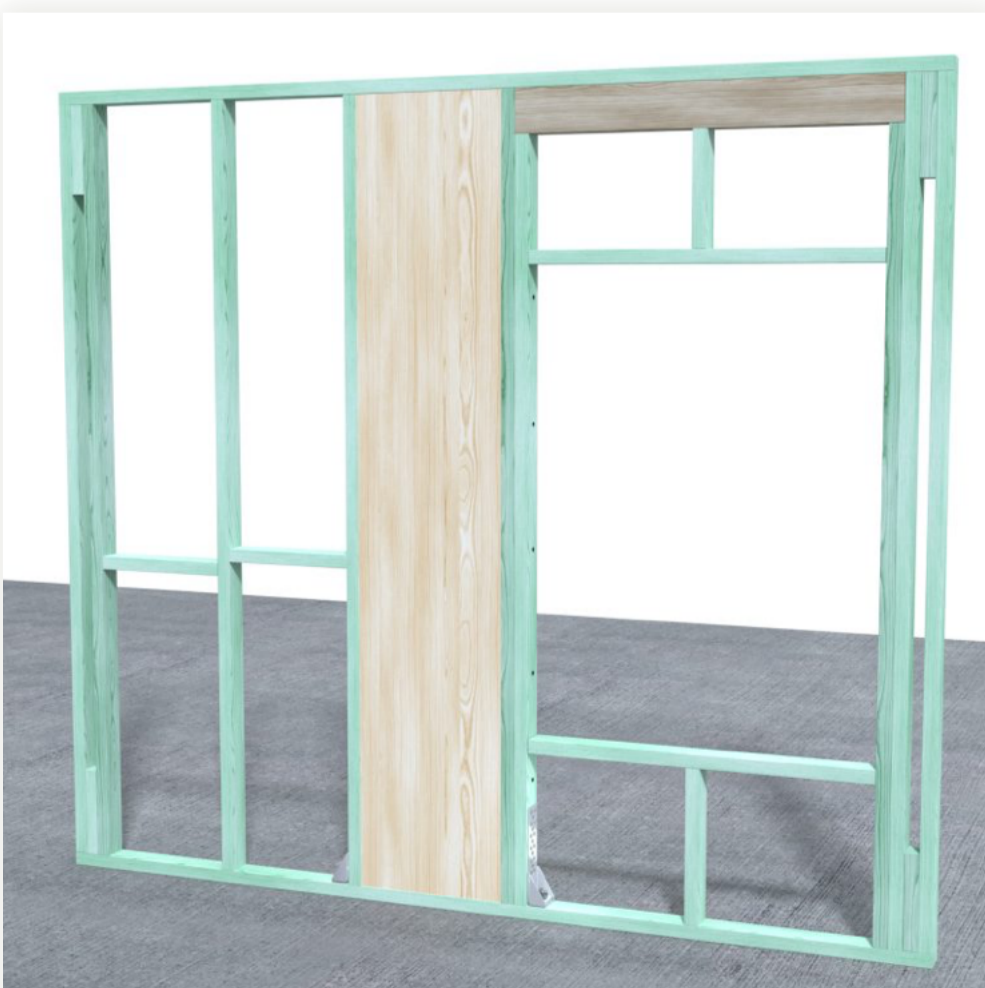

Step 7

Job Done!